

CORONA

Portable Kerosene Heater
 Owner's Manual for **SX-B22A**

IMPORTANT WICK INFORMATION

To maximize the life of the wick and performance of the heater, please read section 8. If this procedure is not performed on a regular basis, the wick will need replacing far too often.

APPEARANCE

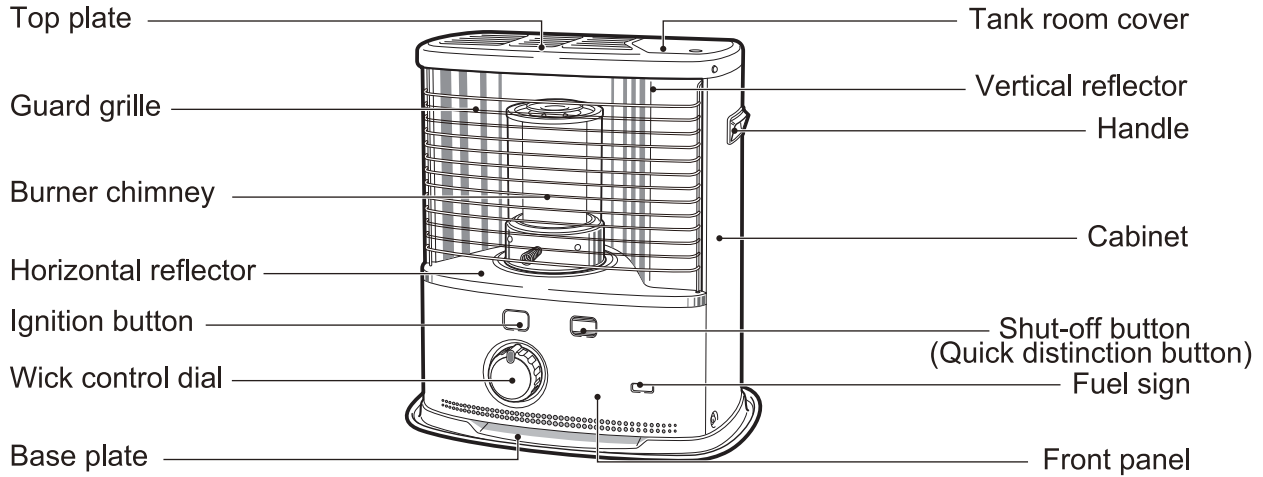

STRUCTURE

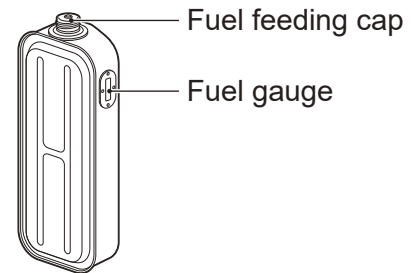
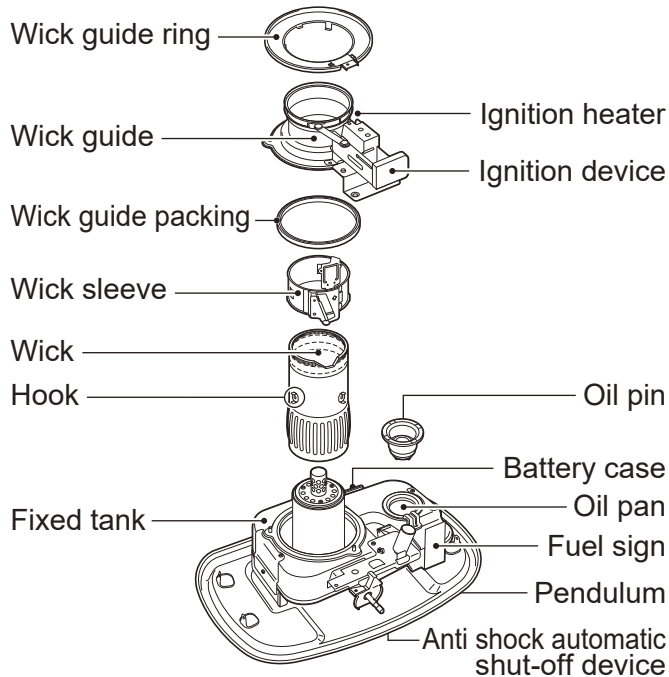

FUEL TANK

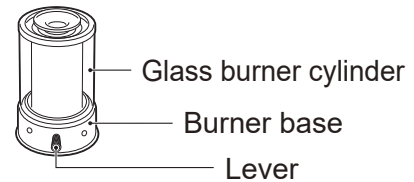

BURNER CHIMNEY

GENERAL SPECIFICATIONS:

Model	SX-B22A
Heating Output	2.24 kW (1,930 kcal/h)
Fuel Consumption	0.218 L/h
Tank Capacity	4.0 liters
Ignition	2.8V ignition plug: 2 "D" size dry cell batteries, 1.5V each
Size: (H)×(W)×(D)	475 × 452 × 324 mm
Weight: (empty)	7.2 kgs

1. Before Using Your Heater, Read These Important Words of Caution

1. Combustion consumes indoor air, so only use your heater in areas where ventilation is possible.
2. Do not place your heater in high traffic areas, nor in places exposed to winds or strong drafts.
3. Your kerosene heater is hot while in operation. Never place your heater closer than 1 meter from combustible materials such as furniture, curtains and clothing.
4. When you move the heater, use the handles on each side of the cabinet.
5. Do not operate the ignition while the heater is already in operation.
6. Never use highly volatile fuels, such as petrol that will dangerously increase the risk of fire. Use only clean, fresh kerosene in your heater. Make sure the container is absolutely clean and dry.
7. Store the kerosene supply in an approved container, tightly capped, preferably in a cool, dark place. Never store in glass containers.
8. Never leave the heater unattended while in use, always extinguish the heater before you go to sleep.
9. Do not use your heater if it has been damaged or is burning irregularly.
10. Make certain the heater is turned "OFF" before filling the tank.
11. Do not move the heater while it is in operation.
12. Do not use the top of the heater for cooking or boiling water as it will affect the operation of the heater.

2. Assembling your CORONA Heater

1. Open the guard grille and remove the packing material from the burner.
2. Open the tank room cover on top of the heater and remove the packing material. Lift out the fuel tank.

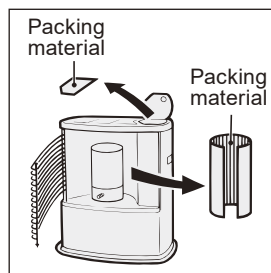

3. Install the burner chimney properly, make sure all of the packing material is removed.

To be certain the burner chimney is properly positioned, grasp the lever as shown and rotate the burner chimney to the left and right two or three times.

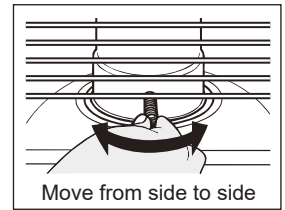

If this doesn't go smoothly, the burner chimney isn't installed correctly.

4. Install the batteries in the holder as indicated by the (+) and (-) polarity markings.

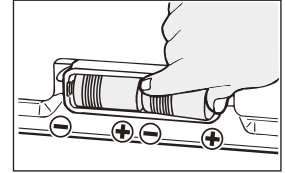

3. Filling the Fuel Tank with Kerosene

CAUTION : Use only clean, fresh kerosene.

1. Open the tank room cover and take out the fuel tank.
2. Always use the siphon pump to fill the fuel tank.

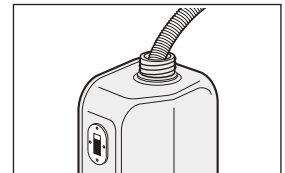

3. When fuel is filled almost to the appropriate level (See illustration) of the fuel gauge, it indicates that the fuel tank is filled with a right amount of kerosene. Do not fill beyond this point.

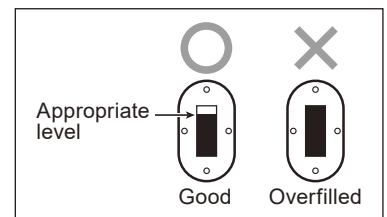

4. Turn the fuel tank upside down. Place the fuel tank into the heater, using the tank handle.

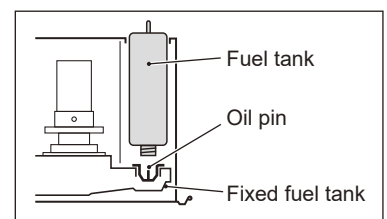

4. Obtaining the Right Quantity of Fuel

< Guide for Refuel: Please confirm by fuel sign >
When the level of fuel is dropping on the fuel tank, the fuel sign will show it. When the fuel sign shows the sign in pink color, please refuel to the fuel tank with referring "Filling the Fuel Tank with Kerosene".

The fuel contained in the tank will be totally gone after about in a few hours.

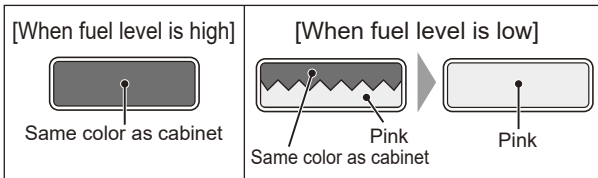

5. Lighting the Heater

IMPORTANT:

When you use the heater for the first time, wait at least 30 minutes before attempting to light it. This time allows the wick to absorb enough kerosene for satisfactory lighting and burning.

1. Turn slowly the wick control dial to right direction (IGNITION POSITION) until it stops to let the wick go up to the maximum level. Push the ignition button gently until it stops.

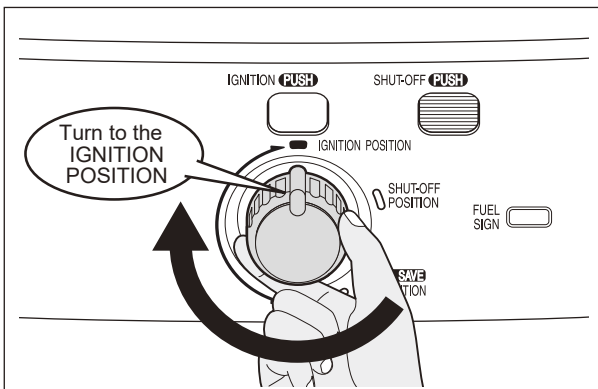

2. Visually check if the unit is burning.
3. After making sure ignition, leave your finger slowly and confirm the ignition button is back to its original position.

IMPORTANT:

After the above mentioned igniting process is done, a fluff of white smoke may rise without actually lighting the heater. If this happens back up the ignition button a fraction of the way and the unit will be lighted.

4. In case the ignition device is unusable, you can ignite the heater with a match. Unfold the guard grille. The un-burned portion of the match should NOT be left in the unit.

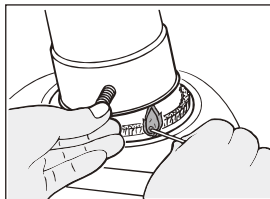

5. After the wick is lighted, check the position of the burner chimney by rotating it left and right two or three times.

6. Adjusting the Wick During Operation

1. Adjustment of flame can be done by the wick control dial:
By watching condition of flame and red glow, adjust by the wick control dial.

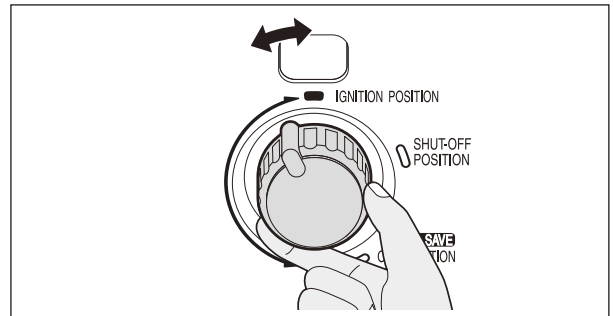

Wick Control Dial	Wick	Flame
Turning right	Rise	High
Turning left	Fall	Low

2. Smoke and odor will result if the heater is operated with the flame too high or too low.

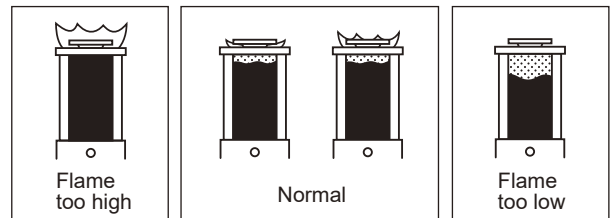

3. Adjusting the wick should always be done slowly and carefully. A jerky motion could rise the flame suddenly to a dangerous height.

7. Turning your Heater off

1. Turn slowly and softly the wick control dial to left (SMELL SAVE OFF POSITION) direction until it stops. (Turn yellow mark on the wick control dial to SMELL SAVE OFF POSITION.)

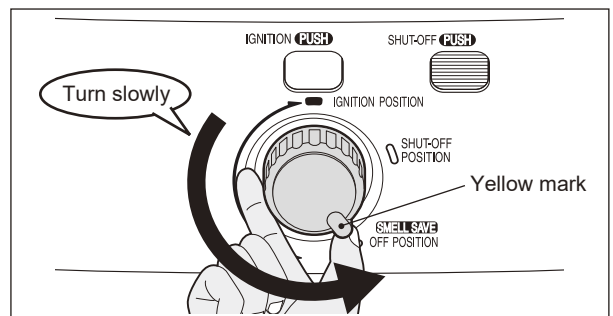

The heater will be completely off in approximately one to three minutes. Make sure that you extinguish the heater completely.

2. In an extreme emergency the anti shock automatic shut-off device can be activated by pressing the shut-off button (the quick distinction button). The wick goes DOWN and the heater will be completely OFF.

IMPORTANT:

Do not use this procedure to extinguish the heater because the rapidity with which it operates will produce smoke and an excessive kerosene odor.

3. When the heater is tipped over, the anti shock automatic shut-off device will extinguish the heater automatically.

IMPORTANT:

After extinction, wait at least five minutes before relighting the heater. The burner chimney is hot and if relighted it will produce smoke and odor.

8. De carboning

1. De carboning the wick regularly will keep it in good condition. Once a week is recommended during seasons of heavy use.

2. Use the heater as normal but do not top up the tank until the heater has used up all the kerosene in the removable fuel tank and in the reservoir beneath the wick. When the flame goes out due to lack of fuel refill the fuel tank, wait until the wick has soaked up some kerosene, and relight the heater.

3. This procedure will normally remove any tar or carbon build up in the wick during normal operation.

4. If you still feel there may be more carbon in the wick only put a small amount of kerosene in the fuel tank and run the heater on high until the flame goes out.

5. Section 6.2 in the manual shows the correct flame height in normal operation of the heater. Should this not be achieved after de carboning you may need to replace the wick.

IMPORTANT:

The first time you use your heater after cleaning the wick, wait at least 30 minutes before attempting to light it. This time allows the wick to absorb enough kerosene for satisfactory lighting and burning.

WARRANTY DETAILS

1 YEAR FROM DATE OF PURCHASE

Proof of purchase:

The purchase docket must be presented with the warranty when making a claim under this warranty.

Extent of warranty:

This warranty is limited to defects in workmanship or parts. All defective products or parts will be repaired or replaced or refunded at our discretion, solely at our option with no charge for parts or labour. Should a problem arise please contact the number listed at the bottom of the warranty sheet OR contact the retailer where the item was purchased.

Our goods come with guarantees that cannot be excluded under the Australian Consumer Law. You are entitled to a replacement or a refund for a major failure and for compensation for any other reasonably foreseeable loss or damage. You are also entitled to have the goods repaired or replaced if the goods fail to be of acceptable quality and the failure does not amount a major failure.

Service during the warranty period:

Please ensure the product is properly packaged so as to ensure that no damage occurs to the product during transit. Also make sure that you have included an explanation of the problem. Should the item need returning Aussie Outdoor Imports will advise the method of return and pay these costs. However, if the fault is not a manufacturing defect and is caused by any of the events listed in the exclusions of this warranty the freight costs, labour and parts will be payable by the customer.

Normal wear and tear.

This warranty does not cover normal wear and tear to the product or parts.

Exclusions:

This warranty does not cover:

- Any defect caused by accident, misuse, abuse, improper installation or operation, lack of reasonable care, unauthorized modification, loss of parts, tampering or attempted repair by a person not authorized by the importer.
- Any product that has been used for purposes other than domestic use.
- The product if it is located outside of Australia

Importer:

Kila Holdings Pty Ltd,
Trading as Aussie Outdoor.
Contact: Cameron Kidd
Telephone : 1800 232 746
Email: ckidd@ozoutdoor.com



CORONA

Portable Kerosene Heater

Manufactured in Japan by CORONA CORPORATION

Printed in Japan